



Havering

LONDON BOROUGH

The Havering you want to be part of

www.havering.gov.uk

Consultation on Proposed SEND Unit at Harrow Lodge Primary School

For Pupils with Communication &
Interaction Needs

Why This Proposal Matters

Havering's Draft SEND and Alternative Provision Strategy emphasises the local authority's vision to ensure children, young people, and families have access to the same level of high-quality support and education, wherever they live in Havering.

While there are a number of schools operating a Communication & Interaction (C&I) SEND unit, additional primary C&I SEND units are required in order to meet the growing number of primary school aged pupils with C&I needs.

A new C&I SEND unit at Harrow Lodge Primary School will help meet key objectives from both the corporate and education visions for Havering.

Addressing an Increasing Demand

We expect the number of children and young people with C&I to increase from 1438 in 2023/24 to 2073 in 2027/28. Projections: Increase in primary pupils with EHCP.

There are currently five primary SEND Units totalling 77 places, catering to the need of C&I.

Academic year	Cognition and Learning	Communication and Interaction	SEMH	Physical and/or Sensory	Totals
2023/2024	603	1438	464	246	2751
2024/2025	668	1611	517	274	3070
2025/2026	722	1770	561	298	3351
2026/2027	781	1938	610	323	3652
2027/2028	842	2073	662	344	3921

With a significant 44.15% increase in demand between 2023/24 and 2027/28, establishing a SEND Unit is essential to effectively address the growing C&I need within the borough.

What we are proposing

Harrow Lodge Primary School is proposing to establish a SEND Unit for 12 pupils with C&I needs to be implemented in September 2026.

The new facility will enable young people with C&I needs to have their needs met through a flexible approach, tailored and adapted to the needs of each individual pupil.

Harrow Lodge Primary School is an outstanding primary school with 450 places across Reception to year 6 including a bulge class in year 4.

Harrow Lodge Primary School has previous experience of meeting the needs of pupils with complex needs. The school has proactively set up a nurture provision to support pupils with additional needs.

Geographically, a SEND unit at Harrow Lodge Primary School would be centrally located within the borough and would be a good geographical position in terms of the location of other of SEND Units within Havering.

Harrow Lodge Primary School has agreed to establish a SEND unit at their school in order to meet the needs of SEND pupils.

Admissions

Admissions into the SEND unit will be through the Havering SEND EHC panel process.

Pupils attending the SEND unit would be in addition to the mainstream Planned Admission Number (PAN) of 60.

There would be 12 planned places in the SEND unit increasing the total number of places from 450 pupils to 462.

Pupils that attend the SEND unit will attract additional funding.

Purpose-Built SEND Facilities

Location Plan & Site Plan

Photos

Landscape & Access

General Arrangements

Elevations & 3D Views

HARROW LODGE PRIMARY SCHOOL

SEND UNIT SITE PLAN



HARROW LODGE PRIMARY SCHOOL

SEND UNIT
SITE PLAN



HARROW LODGE PRIMARY SCHOOL

SEND UNIT

PHOTOS



HARROW LODGE PRIMARY SCHOOL

SEND UNIT

LANDSCAPE & ACCESS



HARROW LODGE PRIMARY SCHOOL

SEND UNIT - PROPOSAL

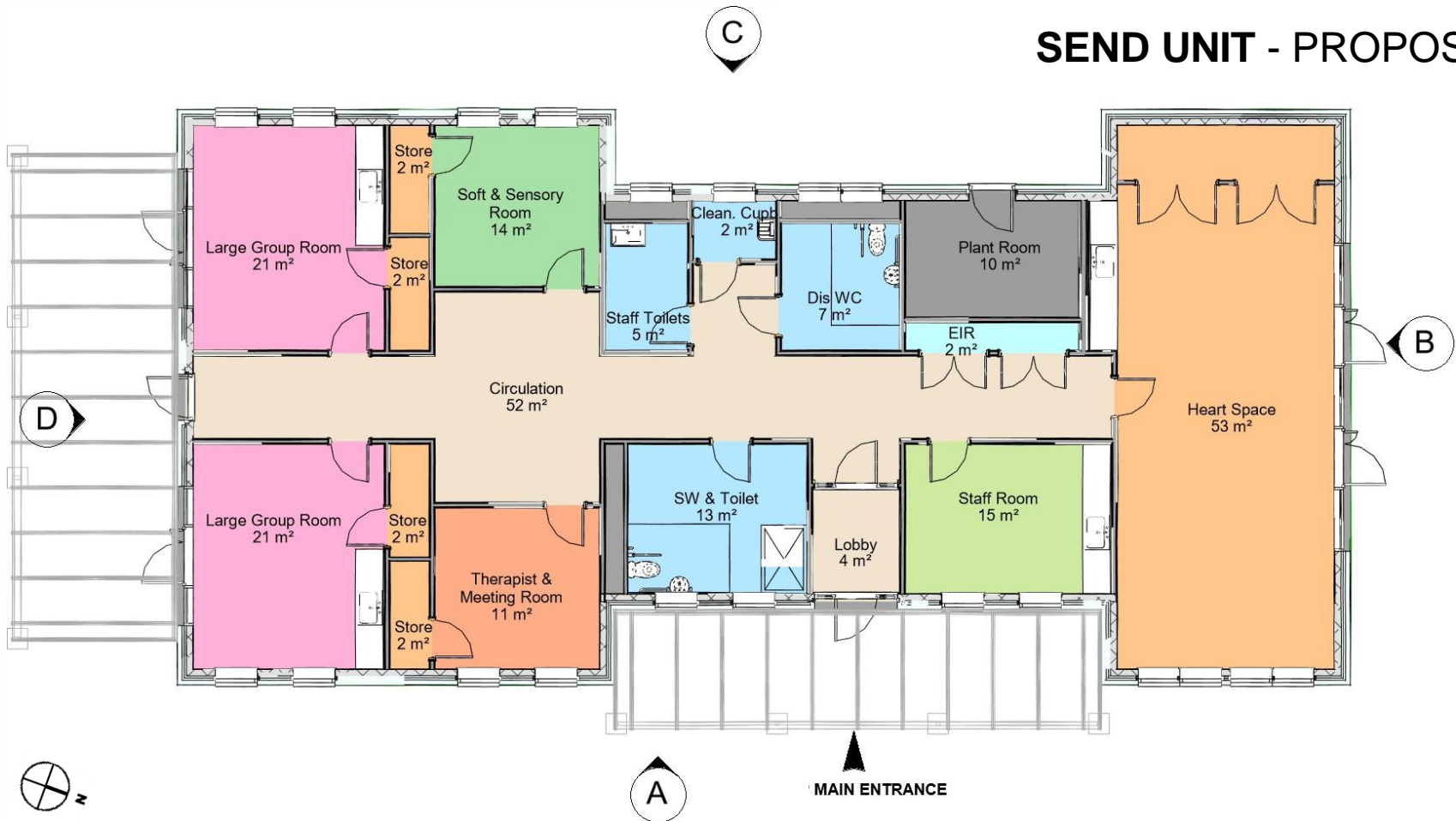

HARROW LODGE PRIMARY SCHOOL SEND UNIT - ELEVATIONS



A - East Elevation with main entrance and facing playing field



B - North Elevation toward Sensory Garden



C - West Elevation toward boundary line



D - South Elevation toward playground

HARROW LODGE PRIMARY SCHOOL SEND UNIT - VIEWS



View from boundary line on back of the SEND block



View from above on the playground



View from the piazza on the SEND Block entrance



View from above on the glazing wall of the Heart Space toward the Sensory garden

Key Dates and Next Steps

Key Milestones	Date
Consultation Period	10/01/2025 – 07/02/2025
Parent/Stakeholder Consultation meeting	27/01/2025
Executive Decision by the LA for approval of the release of funds for implementation of the SEND Unit	March 2025
Submission of application form to the DfE	April 2025
Decision	Summer 2025
Implementation	September 2026

Have Your Say

If you have any other questions regarding this proposal, please email:

lsearle@harrowlodgeprimary.com

Complete the online consultation questionnaire via
consultation.havering.gov.uk or by scanning the QR code:

